

# Table Of Content

---

YL 81F .....	2
YL 61F-F .....	3
L100 .....	4
L183 .....	5
L200 .....	6
KD986 .....	7
KD286 .....	8
KD21C .....	8
500S-U .....	9
BC203 .....	10
SW-LCD .....	11

### Control Switch

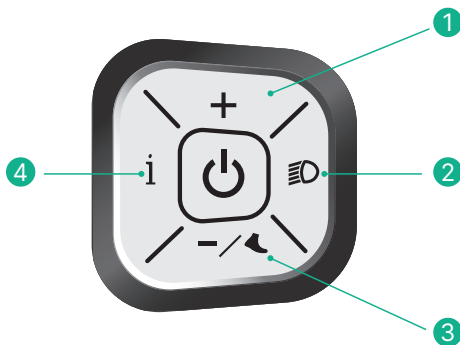

- |                  |                 |
|------------------|-----------------|
| ① "+" button     | ⑤ Battery level |
| ② "light" button | ⑥ Current speed |
| ③ "-" button     | ⑦ Odometer      |
| ④ Mode button    | ⑧ Light on/off  |
|                  | ⑨ PAS level     |

### YL-81F Display



## 1. Power On/Off

Hold the "Ⓜ" button for approx. 2 seconds to turn the bike on/off.  
The bike will auto-shut down after 10 minutes of inactivity.

## 2. Display & Data Switching

When the display is powered on, it will show the Current Speed (km/h) and Trip (km) by default.  
Short press the "i" button to cycle through: TRIP (km) → ODO (km) → MAX (km/h) → Avg (km/h)

## 3. Pedal Assist Adjustment

Short press the "+" button to increase the assist level.  
Short press the "-/🚲" button to decrease the assist level.  
Level 0: No motor assist (pure manual mode)  
Level 1: Default assist level  
Level 5: Maximum assist level

## 4. Push Assist Function

Hold the "-/🚲" button to activate push assist (indicator lights up).  
Release the button to disable the function.  
The push assist mode runs at approx 6 km/h.

## 5. Turning on/off lights

Short press the "💡" button to turn the front light on/off.  
The light indicator will appear/disappear on the display accordingly.

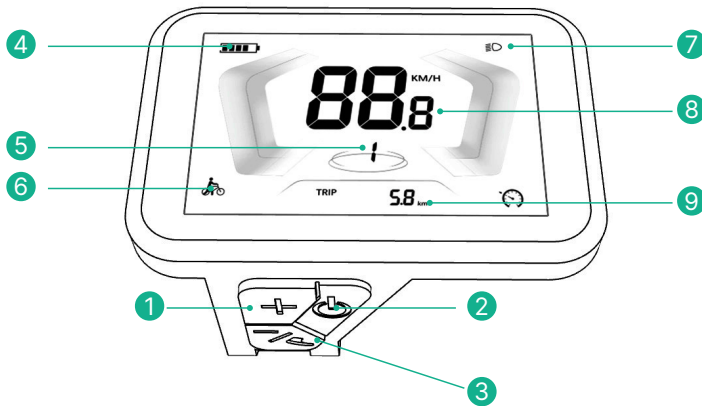

- |                  |                 |                 |
|------------------|-----------------|-----------------|
| ① "+" button     | ④ Battery level | ⑦ Light on/off  |
| ② "POWER" button | ⑤ PAS level     | ⑧ Current speed |
| ③ "-" button     | ⑥ Walk boost    | ⑨ Odometer      |

## 1. Power On/Off

Hold the "⏻" button for approx. 2 seconds to turn the bike on/off.  
The bike will auto-shut down after 10 minutes of inactivity.

## 2. Display & Data Switching

When the display is powered on, it will show the Current Speed (km/h) and Trip (km) by default.  
Short press the "POWER" button to cycle through: TRIP (km) → ODO (km) → MAX (km/h) → Avg (km/h)

## 3. Pedal Assist Adjustment

Short press the "+" button to increase the assist level.  
Short press the "-/🚲" button to decrease the assist level.  
Level 0: No motor assist (pure manual mode)  
Level 1: Default assist level  
Level 5: Maximum assist level

## 4. Push Assist Function

Hold the "-/🚲" button to activate push assist (indicator lights up).  
Release the button to disable the function.  
The push assist mode runs at approx 6 km/h.

## 5. Turning on/off lights

Short press the "💡" button to turn the front light on/off.  
The light indicator will appear/disappear on the display accordingly.

### Control Switch

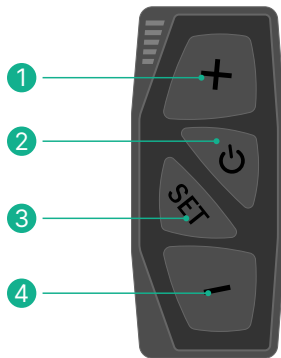

- ① "+" button
- ② "POWER" button
- ③ "SET" button
- ④ "-" button

### L100 Display



- ⑤ Battery level
- ⑥ Current speed
- ⑦ Odometer
- ⑧ Headlight status
- ⑨ PAS level

## 1. Power On/Off

Hold the "⏻" button for approx. 2 seconds to turn the bike on/off.  
The bike will auto-shut down after 10 minutes of inactivity.

## 2. Display & Data Switching

The display shows the current speed by default  
Short press the "SET" button to cycle through: TRIP (km) → ODO (km).

## 3. Riding Mode Switching

Hold the "+" button to cycle through riding modes: ECO → NOR → POW.

## 4. Pedal Assist Adjustment

Short press the "+" button to increase the assist level.  
Short press the "-" button to decrease the assist level.  
Level 0: No motor assist (pure manual mode)  
Level 1: Default assist level  
Level 5: Maximum assist level

## 5. Push Assist Function

Hold the "-" button to activate push assist (indicator lights up).  
Release the button to disable the function.  
The push assist mode runs at approx 6 km/h.

## 6. Turning on/off lights

Short press the "⏻" button to turn the front light on/off.  
The light indicator will appear/disappear on the display accordingly.

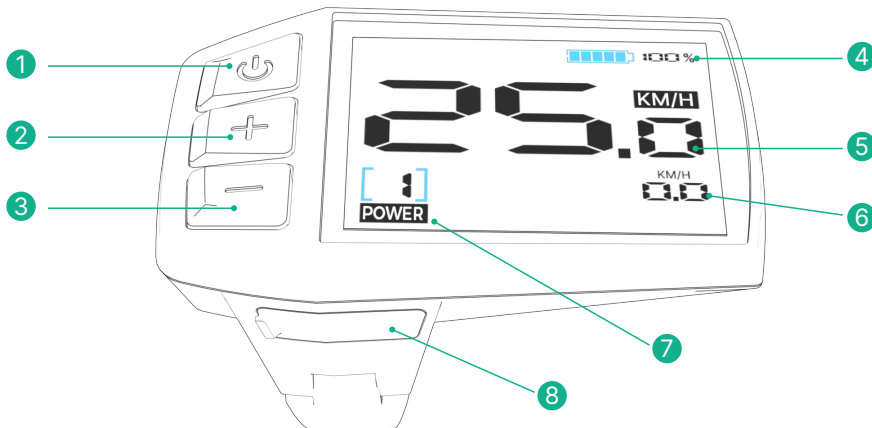

- |                  |                 |                |
|------------------|-----------------|----------------|
| ① "POWER" button | ④ Battery level | ⑦ Assist level |
| ② "+" button     | ⑤ Current speed | ⑧ USB port     |
| ③ "-" button     | ⑥ Data area     |                |

## 1. Power On/Off

Hold the "POWER" button for approx. 2 seconds to turn the bike on/off.  
The bike will auto-shut down after 10 minutes of inactivity.

## 2. Switch assist level

Short press the "+" button to increase the assist level; short press the "-" button to decrease the assist level.  
Press and hold the "-" button to start walk mode, and release the "-" button to exit walk mode.

## 3. Clear trip

Long press the "POWER" button and "+" button combination to clear trip

## 4. Switch data display

In the main interface, short press the "POWER" button to switch to view different data information.  
Switch data display order: Riding time → Trip mileage → Total mileage → Average speed → Maximum speed.

## 5. Menu operation

- Whenspeed is 0, long press "+" and "-" button combination for 2s to enter user menu interface.
- After entering the menu interface, short press the "POWER" button to select the setting option.
- Short press "+" or "-" button to adjust the value.
- Longpress "+" and "-" button combination for 2s to exit user menu interface.

## 6. Turn on/off the light

Long press "+" button to turn on/off the light.



- ① "Power" button
- ② Light on/off
- ③ Battery level
- ④ Assist level
- ⑤ Current speed
- ⑥ Multi-function display area
- ⑦ "+" button
- ⑧ "-" button

## 1. Power On/Off

Hold the  button for approx. 2 seconds to turn the bike on/off.  
The bike will auto-shut down after 10 minutes of inactivity.

## 2. Switch assist level

Short press the "+" button to increase the assist level; short press the "-" button to decrease the assist level.  
Press and hold the "-" button to start walk mode, and release the "-" button to exit walk mode.

## 3. Clear trip

Long press the  button and "+" button combination to clear trip

## 4. Switch data display

In the main interface, short press the  button to switch to view different data information.  
Switch data display order: Riding time → Trip mileage → Total mileage → Average speed → Maximum speed.

## 5. Menu operation

- Whenspeed is 0, long press "+" and "-" button combination for 2s to enter user menu interface.
- After entering the menu interface, short press the  button to select the setting option.
- Short press "+" or "-" button to adjust the value.
- Longpress "+" and "-" button combination for 2s to exit user menu interface.

## 6. Turnon/off the light

Long press "+" button to turn on/off the light.

### Control Switch

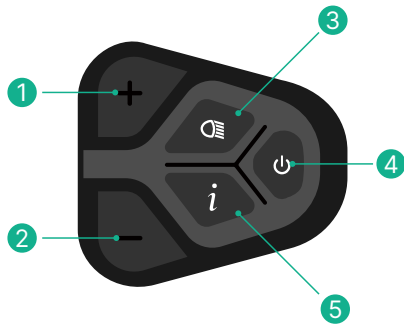

- |                  |                 |
|------------------|-----------------|
| ① "+" button     | ⑥ Battery level |
| ② "-" button     | ⑦ Current speed |
| ③ "Light" button | ⑧ Light on/off  |
| ④ "Power" button | ⑨ Assist level  |
| ⑤ "Info" button  |                 |

### KD986 Display

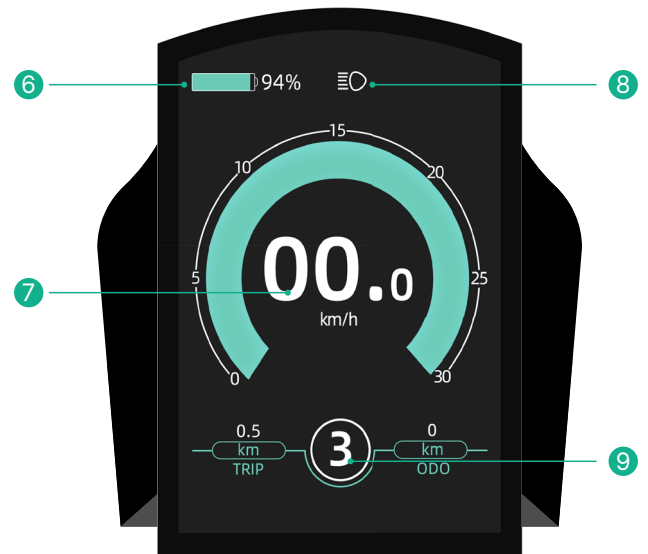

#### 1. Power On/Off

Hold the "⏻" button for approx. 2 seconds to turn the bike on/off.  
The bike will auto-shut down after 10 minutes of inactivity.

#### 2. Display & Data Switching

When the display is powered on, it will show the Current Speed (km/h) and Trip (km) by default.  
Short press the "i" button to cycle through: TRIP (km) → ODO (km) → MAX (km/h) → Avg (km/h)

#### 3. Pedal Assist Adjustment

Short press the "+" button to increase the assist level.

Short press the "-" button to decrease the assist level.

Level 0: No motor assist (pure manual mode)

Level 1: Default assist level

Level 5: Maximum assist level

#### 4. Push Assist Function

Hold the "-" button to activate push assist (indicator lights up).

Release the button to disable the function.

The push assist mode runs at approx 6 km/h.

#### 5. Turning on/off lights

Short press the "☹️" button to turn the front light on/off.

The light indicator will appear/disappear on the display accordingly.

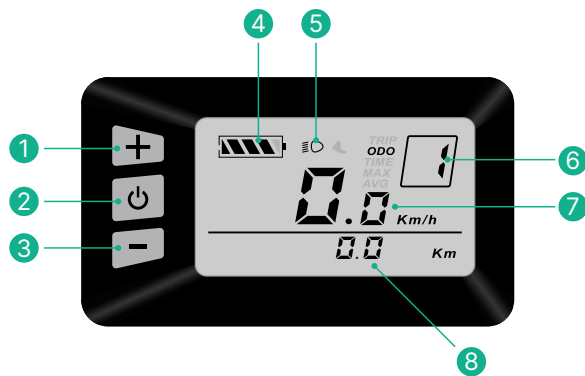

- ① "+" button
- ② "Power" button
- ③ "-" button
- ④ Battery level
- ⑤ Light on/off
- ⑥ Assist level
- ⑦ Current speed
- ⑧ Odometer

### 1. Power On/Off

Hold the "Power" button for approx. 2 seconds to turn the bike on/off.  
The bike will auto-shut down after 10 minutes of inactivity.

### 2. Display & Data Switching

When the display is powered on, it will show the Current Speed (km/h) and Trip (km) by default.  
Short press the "+" button to cycle through: TRIP (km) → ODO (km) → MAX (km/h) → Avg (km/h)

### 3. Pedal Assist Adjustment

Short press the "+" button to increase the assist level.

Short press the "-" button to decrease the assist level.

Level 0: No motor assist (pure manual mode)

Level 1: Default assist level

Level 5: Maximum assist level

### 4. Push Assist Function

Hold the "-" button to activate push assist (indicator lights up).

Release the button to disable the function.

The push assist mode runs at approx 6 km/h.

### 5. Turning on/off lights

Short press the "+" button to turn the front light on/off.

The light indicator will appear/disappear on the display accordingly.

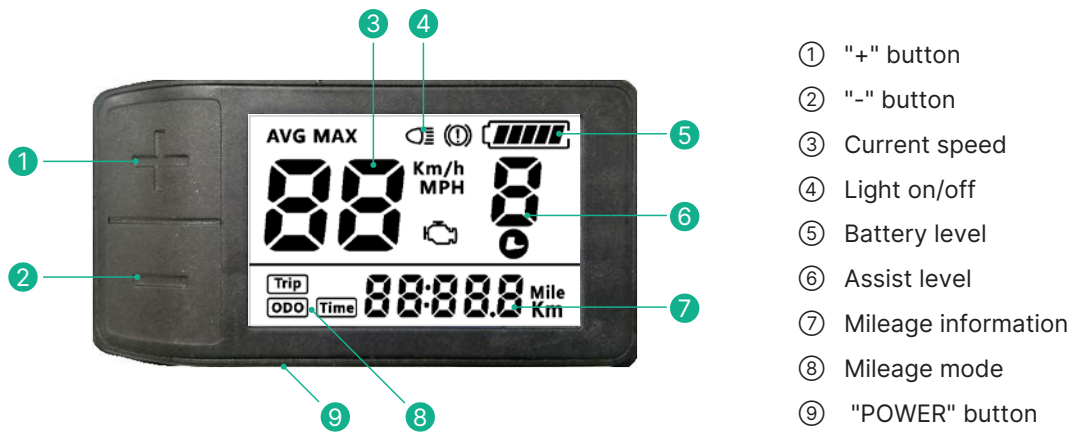

- ① "+" button
- ② "-" button
- ③ Current speed
- ④ Light on/off
- ⑤ Battery level
- ⑥ Assist level
- ⑦ Mileage information
- ⑧ Mileage mode
- ⑨ "POWER" button

## 1. Power On/Off

Hold the "⏻" button for approx. 2 seconds to turn the bike on/off.  
The bike will auto-shut down after 10 minutes of inactivity.

## 2. Display & Data Switching

When the display is powered on, it will show the Current Speed (km/h) and Trip (km) by default.  
Short press the "⏻" button to cycle through: AVG (km) → MAX (km) → TRIP (km/h) → ODO (km/h) → TIME.

## 3. Pedal Assist Adjustment

Short press the "+" button to increase the assist level.  
Short press the "-" button to decrease the assist level.  
Level 0: No motor assist (pure manual mode)  
Level 1: Default assist level  
Level 5: Maximum assist level

## 4. Push Assist Function

Hold the "-" button to activate push assist (indicator lights up).  
Release the button to disable the function.  
The push assist mode runs at approx 6 km/h.

## 5. Turning on/off lights

Short press the "+" button to turn the front light on/off.  
The light indicator will appear/disappear on the display accordingly.

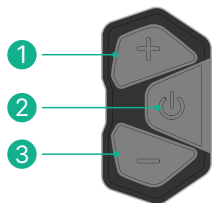
**Control Switch**

- ① "+" button
- ② "Power" button
- ③ "-" button

**BC203 Display**

- ④ Headlight status
- ⑤ Battery level
- ⑥ Real-time speed
- ⑦ Assist level

### 1. Power On/Off

Hold the "Power" button for approx. 2 seconds to turn the bike on/off.  
The bike will auto-shut down after 10 minutes of inactivity.

### 2. Display & Data Switching

When the display is powered on, it will show the Current Speed (km/h) and Trip (km) by default.  
Short press the "+" button to cycle through: TRIP (km) → ODO (km) → MAX (km/h) → Avg (km/h)

### 3. Pedal Assist Adjustment

Short press the "+" button to increase the assist level.

Short press the "-" button to decrease the assist level.

Level 0: No motor assist (pure manual mode)

Level 1: Default assist level

Level 5: Maximum assist level

### 4. Push Assist Function

Hold the "-" button to activate push assist (indicator lights up).

Release the button to disable the function.

The push assist mode runs at approx 6 km/h.

### 5. Turning on/off lights

Short press the "+" button to turn the front light on/off.

The light indicator will appear/disappear on the display accordingly.

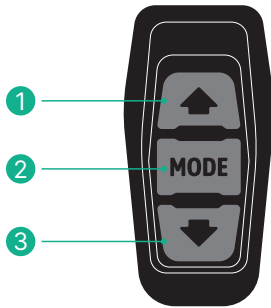
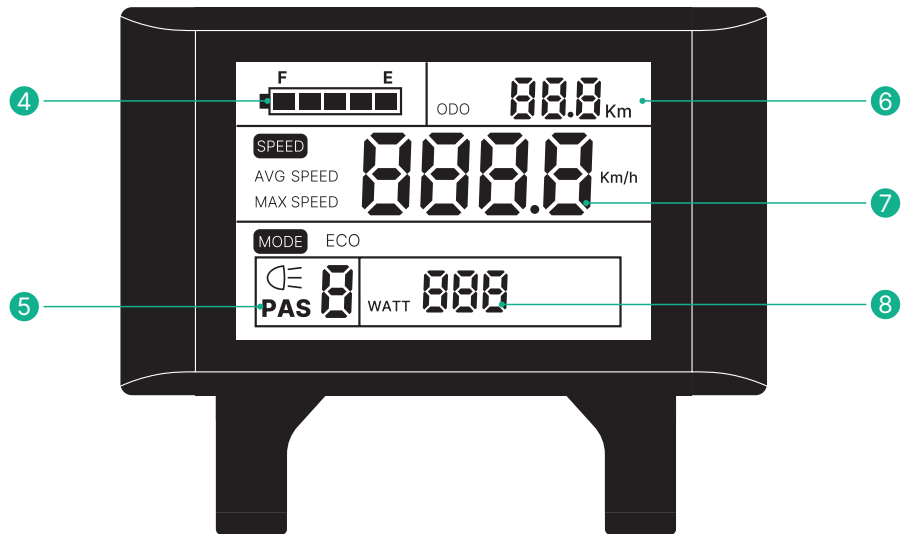
**Control Switch**

**SW-LCD Display**

- |                 |                 |                 |
|-----------------|-----------------|-----------------|
| ① "UP" button   | ④ Battery level | ⑦ Current speed |
| ② "MODE" button | ⑤ PAS level     | ⑧ Error code    |
| ③ "DOWN" button | ⑥ Odometer      |                 |

**1. Power On/Off**

Hold the **"MODE"** button for approx. 2 seconds to turn the bike on/off.  
The bike will auto-shut down after 10 minutes of inactivity.

**2. Display & Data Switching**

The display shows the current speed by default

Short press the **"MODE"** button to cycle through: TRIP (km) → ODO (km).

Press and hold the **"MODE"** and **"DOWN"** buttons for 2 seconds to cycle through: AVG (average speed) → MAX (maximum speed) → Current speed display.

**3. Pedal Assist Adjustment**

Short press the **"UP"** button to increase the assist level.

Short press the **"DOWN"** button to decrease the assist level.

Level 0: No motor assist (pure manual mode)

Level 1: Default assist level

Level 5: Maximum assist level

**4. Push Assist Function**

Hold the **"DOWN"** button to activate push assist (indicator lights up).

Release the button to disable the function.

The push assist mode runs at approx 6 km/h.

**5. Turning on/off lights**

Short press the **"UP"** button to turn the front light on/off.

The light indicator will appear/disappear on the display accordingly.